

IP 68



PLASTIC CABLE GLANDS Exe

Polyamide body / neoprene gasket

TECHNICAL DATA

Apparatus category:	II 2GD
Marking of explosion protection:	Ex e
Ambient temperature:	$-35\text{ °C} \leq T_{\text{amb}} \leq +95\text{ °C}$
Degree of protection:	IP 68

MODEL CODE

THREADS	CLAMPING RANGE	H (mm)	E (mm)	L (mm)	RAL 5012	RAL 9005
M12	4,0 - 6,0	15	15	39	F7431200E	F8031200E
M16	6,0 - 10,0	22	15	44	F7431600E	F8031600E
M20	7,0 - 12,0	24	15	45	F7432050E	F8032050E
M25	10,0 - 18,0	33	15	53	F7432500E	F8032500E
M25	7,00 - 15,0	33	15	53	SPU 25 B	SPU 25
M32	17,0 - 24,0	42	15	57	F7433200E	F8033200E
M40	17,0 - 31,0	53	16	68	F7434000E	F8034000E
M50	24,5 - 37,0	50	16	71	F7435000E	F8035000E
M63	34,0 - 47,0	70	16	72	F7436300E	F8036300E

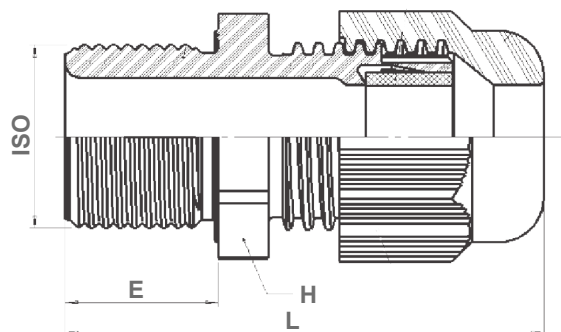

- Ex e plastic cable glands
- Ex d metal cable glands for armored cable

Cable glands, plugs, adapters, reducers, locknuts



METAL Ex d/e CABLE GLANDS (double sealing, for armoured cable) type 4F

Brass nickel plated (AISI 316 on special request)

TECHNICAL DATA

Apparatus category:	II 2GD
Marking of explosion protection:	 Ex d/e
Ambient temperature:	$-40\text{ °C} \leq T_{\text{amb}} \leq +95\text{ °C}$
Degree of protection:	IP 68

MODEL CODE

THREADS	CLAMPING RANGE	H (mm)	E (mm)	CODE
M16	7,0 - 12,0	20	16	4114169
M20	9,0 - 16,0	24	16	4114219
M20	13,0 - 21,0	28	16	4114229
M25	13,0 - 21,0	30	16	4114279
M25	17,0 - 27,5	36	16	4114279
M32	22,0 - 34,0	44	16	4114339
M40	28,0 - 41,0	50	16	4114419
M50	34,0 - 48,0	64	16	4114519
M63	39,0 - 54,0	70	16	4114639
M63	48,0 - 65,0	80	16	4114649
M75	55,0 - 74,0	90	18	4114769

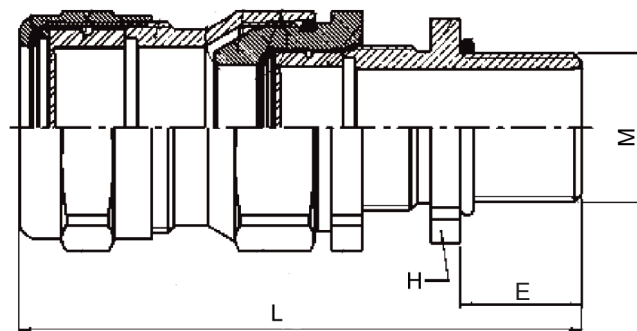

OTHER ACCESSORIES



Other accessories (Exd metal plugs, Exe plastic plugs, adapters, reducers, locknuts, earth tags) are available according to customer request.

All technical data is relevant at the time of print.